

PYGMY POSSUM LODGE, LOT108 CHARLOTTE PASS
Bushfire – Asset Protection Zone.
August 7, 2024

Figure 1: APZ Drawing base data with Lot 108 & building outline. Purple boundary is from Biodiversity Value map. Green lines show areas of tree canopy. Blue is Lot 108.

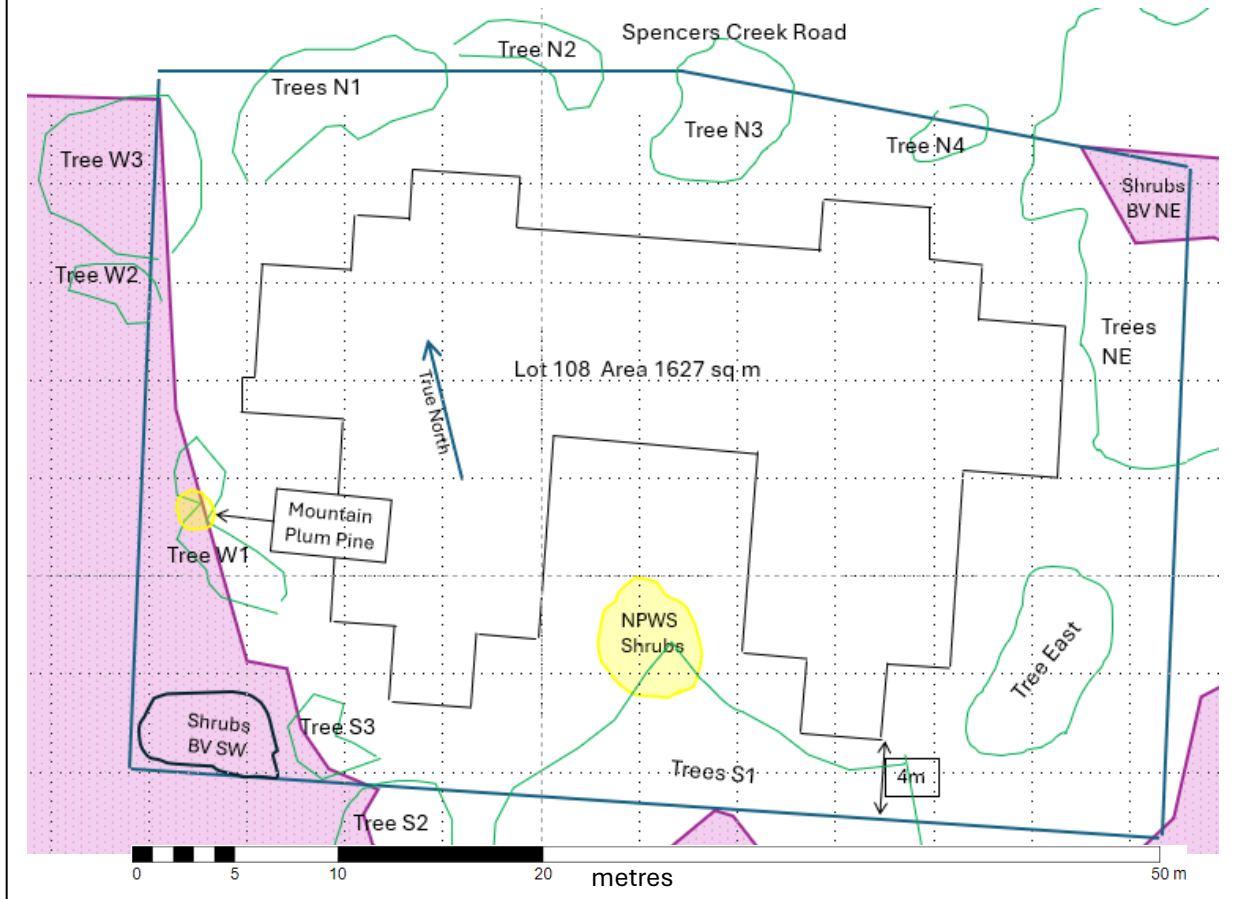

Figure 2: Aerial photo of lodge and tree canopy on 26 July 2024 at 11am. Canopy outlines in Figure 1 taken from this image. Tree canopy outlines in green. Lot 108 boundary in red.

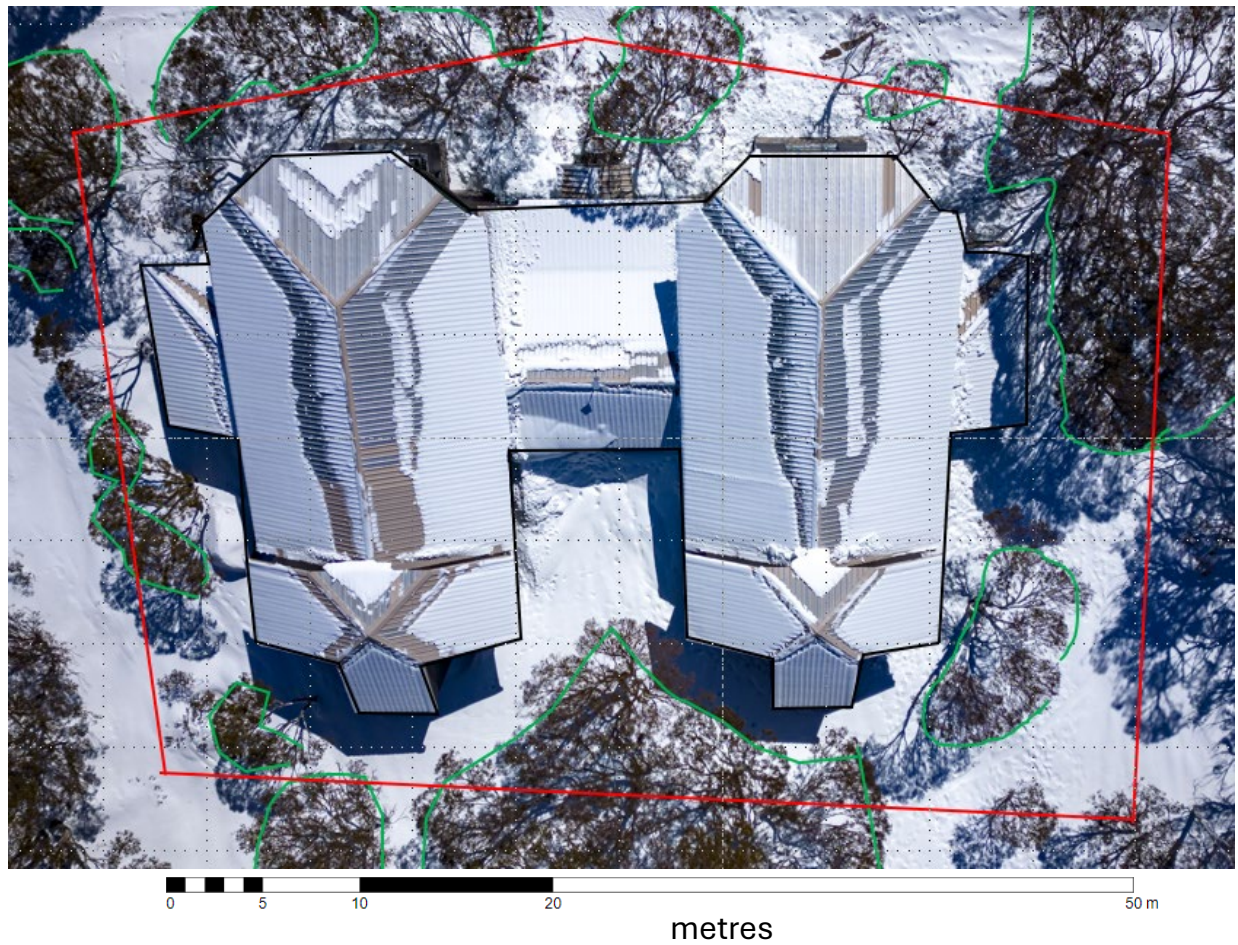

Table 1: Shrub Cover Calculations ("As is" August 2, 2024) Based on areas in Figure 1.			
Shrub Label	Length metres	Width metres	Shrub Area sqm
BV NE	5.3	2.65	14.0
NPWS	5	5.6	28.0
BV SW	7	3.9	27.3
Total			69.3

Table 2: Tree Canopy Calculations (“As is” 2 August 2024)				
Tree area	Length	Width	Percent	Canopy
Label	Metres ¹	Metres ¹	Canopy ²	Area sqm
N1	9.0	2.2	70%	13.9
N2	1.4	2.2	70%	2.2
N3	4.5	4.5	50%	10.1
N4	3.3	1.4	20%	0.9
NE	14.2	5.7	100%	80.9
East	9.0	4.2	50%	18.9
S1	17.3	3.6	80%	49.8
S2 (off lot)	0	0	100%	-
S3	3.1	1.7	100%	5.3
W1	4.2	2.2	100%	9.2
W2 (off lot)	0	0	100%	-
W3	1.7	5.3	100%	9.0
Total				200.2
Note 1: Dimensions are based on Figure 1 shapes, clipped to Lot 108.				
Note 2: Percent canopy is based on leaf cover in Figure 2.				

Table 3: General Measures for ongoing management of APZ.
1. Removal of all fine fuels such as leaves, twigs, bark etc surrounding the building
2. Removal of any branches that are overhanging the building whether live or dead
3. Removal of all dieback trees as they present.
4. Trimming of any heath to <500mm in height; and
5. Mowing grasses to <100mm in height
6. Prune or remove trees to maintain a non-continuous canopy and a crown separation of 2-5m

Table 4: Specific Measures for ongoing management of APZ.	
Area	Notes
Trees S1	Trim branches to reduce canopy & set back 3-5m from building. Canopy is too close to the building. Canopy reduced to 20% overall in this area. No trees need full removal
Trees NE	The canopy closest to the lodge will be thinned and set back 3-5m from the building. Canopy reduced to 80% overall in this area. No trees need full removal.
Shrubs BV NE & BV SW ¹	The biodiversity value areas (BV NE & BV SW) contain shrubs. These shrubs are to be retained & areas delineated during construction activity
Shrubs NPWS ¹	This area is to be retained as shrub as per NPWS Letter of May 20, 2024. Area to be delineated during construction activity.
Mountain Plum Pine ¹	This specimen of Mountain Plum is to be retained and not trimmed as per NPWS Letter of May 20, 2024. Area to be delineated during construction activity.
Note 1: All three above areas	Members, guests and tradesmen are to be educated on the importance of retaining these three areas “as is”.

Table 5: Tree Canopy Calculations ("To be" after trimming)				
Tree Label	Length	Width	Percent	Canopy
	metres	metres	Canopy	Area sqm
N1	9	2.2	70%	13.9
N2	1.4	2.2	70%	2.2
N3	4.5	4.5	50%	10.1
N4	3.3	1.4	20%	0.9
NE (reduced % canopy)	14.2	5.7	80%	64.8
East	9	4.2	50%	18.9
S1 (reduced % canopy)	17.3	3.6	20%	12.5
S2 (off lot)	0	0	100%	-
S3	3.1	1.7	100%	5.3
W1	4.2	2.2	100%	9.2
W2 (off lot)	0	0	100%	-
W3	1.7	5.3	100%	9.0
Total				146.7

Table 6: Calculations of APZ after Table 5 work.	
APZ is entire area within the sub lease boundaries excluding the building footprint.	
Total sub-lease land area (from sub-lease plan of subdivision)	1627 sq m
Lodge Building Footprint (from physical dimensions)	605 sq m
APZ area by subtraction	1022 sq m
Shrub area, areas NPWS, BV NE & BV SW from Table 1	69sq m = 7% of APZ area
Tree canopy area, following changes in area NE & S1 (Table 5)	147 sq m = 14% of APZ area

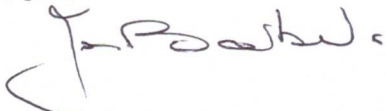
Signed  Date 7 Aug 2024.	Name: Jon Barber	Position: Elouera Ski Club Ltd Director & President
---	-------------------------	---